

home



THERMOPLASTIC

Material for series 2825 & 2837: 20% Talc-filled Polypropylene

Material for series 2800 & 2810: Nylon

Insert- Brass

Projecting Stud- Steel, zinc plated

† Insert - Steel, zinc plated

THE FOUR ARM



Threaded Insert

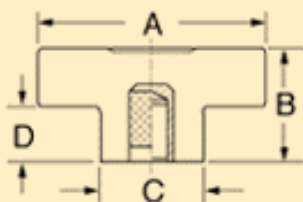

Threaded Insert

Part No.	Insert	
	Thread	Depth
2800-B	10-24	3/8
2800-C	1/4-20	3/8
2800-D	10-32	3/8
2800	8-32	3/8

Threaded Insert Thru Hole

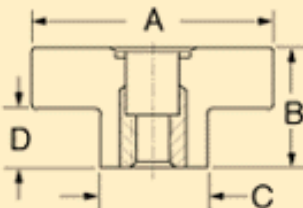

Projecting Stud

Part No.	Stud		Max Length
	Thread	Length	
2800-G	10-32	7/16	2
2800-M	1/4-20	1	2

Projecting Stud

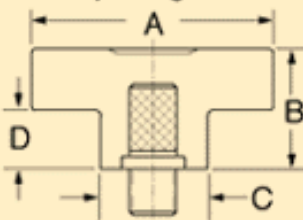

← back